



Surge Protection

For comprehensive protection of a luminaire against electrical surges, surge protection shall be installed on the mains supply where required to protect luminaires and drivers from transient voltage damage.

For warranty information visit unios.com/warranty

Please read these installation instructions carefully before installing this luminaire. This product must be installed and maintained by a suitably qualified person/s in compliance with the latest applicable regulations and relevant legislation.

Unios does not warrant any claim based on defects or damage caused by misuse, improper installation, improper operation and/or modifications carried out by the purchaser or third parties. This luminaire will not be used as a 'Working light' during construction. This will result in the warranty of the luminaire to be void. For warranty duration, please refer to the data sheet.

Minimum clearance for luminaire

① Risk of Fire – Required clearance from structure members and building elements. Details below:

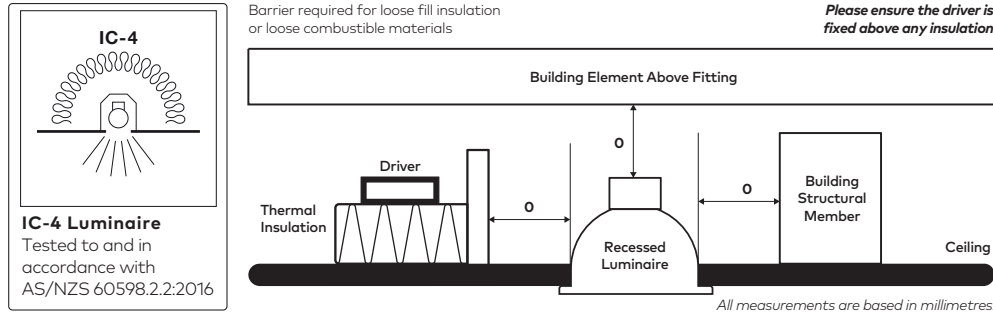

Cleaning

Always clean carefully using a soft cloth and a ph-neutral, alcohol-free, non-abrasive cleaning cloth.

Clean & Maintain the finish twice a year to avoid rust, oxidation or limescale deposits.

Disposal

Ensure correct disposal of this product (waste electrical and electronic equipment)



ION S Track Light
Installation Instructions

unios.com/ionstrackims



ION S Surface Mounted Spotlight
Installation Instructions

unios.com/ionssmims



ION S

RECESSED SPOTLIGHT

Base Codes	Small IONSSR08	Medium IONSMR18	Large IONSLR32	Medium Framer IONFMR18	Large Framer IONFLR32	IP20	Energy Star	RoHS
Class III Luminaire only	IC Rating IC-4	Material Aluminium	Operating Temp <25°C	Install Person/s 1x	Power 8-32 Watts			



CAUTION – This product must be installed by a qualified installer

Please read instruction manual carefully before installing luminaire

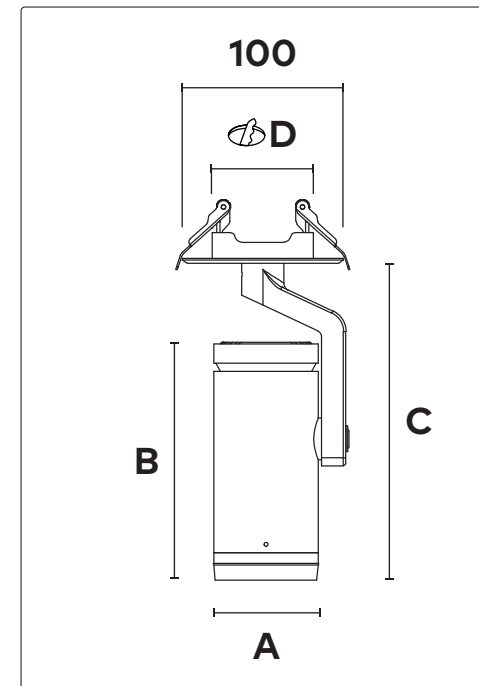

Sizing Variations

Product Code	A	B	C	ØD
IONSSR08	Ø50	125	168	Ø76
IONSMR18	Ø65	148	197	Ø76
IONSLR32	Ø85	160	209	Ø63
IONFMR18	Ø65	148	197	Ø63
IONFLR18	Ø85	160	209	Ø63

All measurements are in millimetres.

Additional Accessories

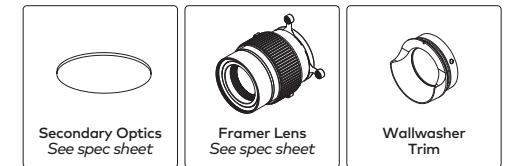

Product Assembly

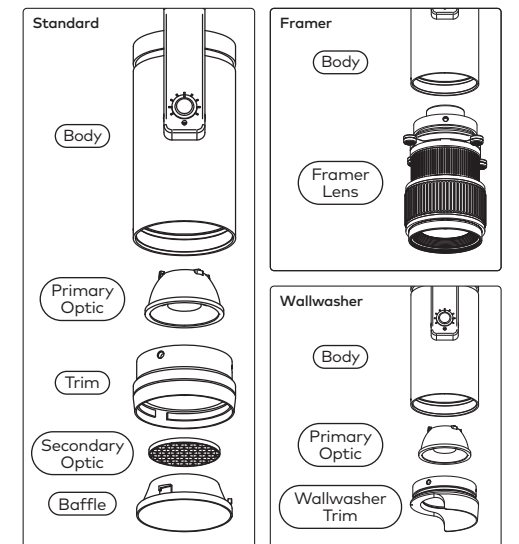

Product Installation

CAUTION

Switch off main electrical power prior to installing and powering this luminaire.

Do not open luminaire whilst the main electrical power is active.

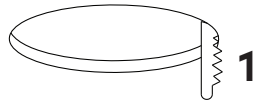
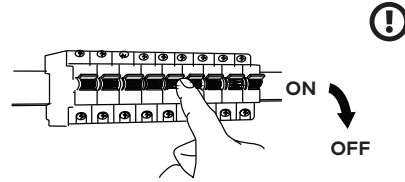

Small/Medium: 76mm

Large/Medium Framer/Large Framer: 63mm

Cut out a hole with the diameter suitable for your spotlight

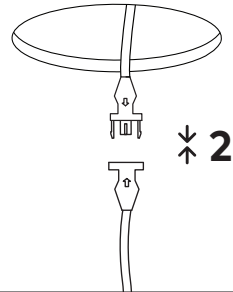

Connect luminaire to remote driver with supplied matching SELV plug

Inserting Luminaire

Small/Medium

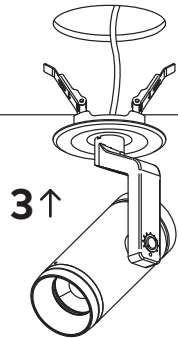

Fold back spring clips and insert luminaire carefully until plate sits evenly with surface

OR

Large/Medium Framer/
Large Framer

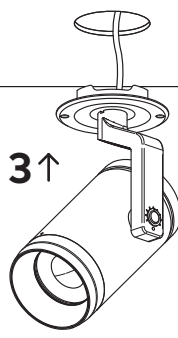

Insert luminaire carefully until plate sits evenly with the surface

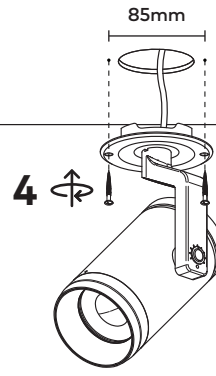

2x M4 screws included for large model

Fasten plate to surface using supplied 2x M4 screws (Anchors are not included)

Wiring

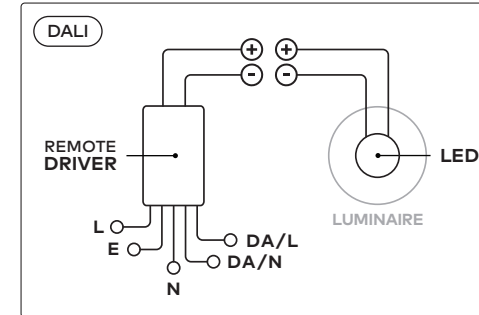
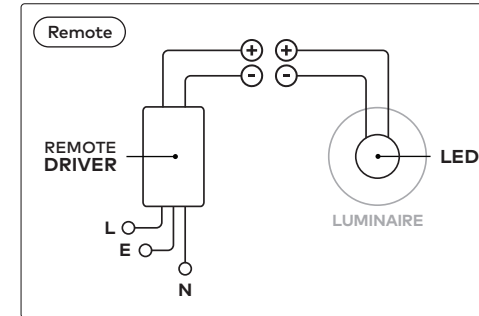

Dimming

Standard models are phase-cut Dimmable. Unios recommends a phase-cut dimmer optimised for LED technology. DALI compatible drivers are also available.

For full list of compatible drivers, see unios.com

Product Adjustment

The inner notch of dial located on the arm indicates current tilt angle. Use diagram below for reference.

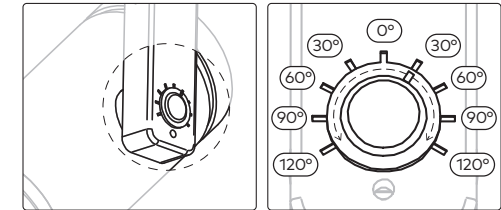
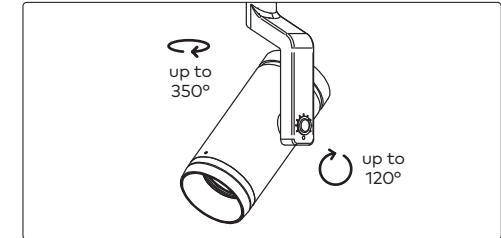

Wallwasher Assembly

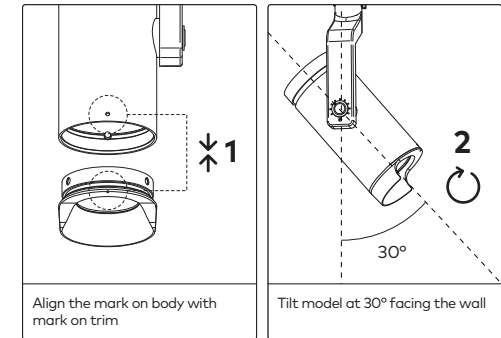

Spacing Recommendation

Applies for wallwasher models intended for wallwashing.

